

VarioBond

A High Performance Airtight Plasterable Junction Tape
For Windows, Doors and Timber to Block Connections



Want to know more?
Watch our Movie!

ISOVER
SAINT-GOBAIN

Sustainable insulation solutions



VarioBond

For use with our VARIO membranes as part of our VARIO Airtightness and Moisture management system

- ✓ Multi-application
– Internal & External use *
- ✓ Plasterable
– can be plastered or rendered over **
- ✓ High Adhesive strength
– bonds to variety of substrates
- ✓ Airtight, Windtight and Driving rain proof
- ✓ Pre-split, with finger-lift function for easy installation

JUNCTIONS

- ✓ Timber wall plate
- ✓ Internal Windows
- ✓ External Windows
- ✓ Internal Floors

SUBSTRATES

Vario Membrane, Timber, PVC, Concrete Block, Metal & Concrete Lintels, PVC Cavity Closers



* The surface on which the tape is installed must be free from releasing film (e.g., moisture, ice or frost) which would prevent contact of the adhesive with the surface.

** Can be used with Gypsum based undercoat plasters, sand and cement and exterior renders.

The Vario System – The Intelligent Airtightness and Moisture Control System

The ISOVER Vario System is an intelligent airtightness and moisture control system, consisting of a range of intelligent membranes, tapes and sealant. This innovative system is designed to adapt to the climate and protect your building, inside and out.

Other products from the Vario Range

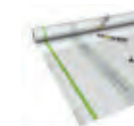

VARIO XTRASAFE

The intelligent membrane for greater safety.
This membrane offers a higher variability for optimum protection. The membrane can be simply and quickly installed by just one worker. Thanks to its innovative fleece material - it is self adhering to Vario XtraFix for easy application and release.



VARIO XTRAFIX

The fixative strip for positioning Vario XtraSafe Intelligent membrane.
With the on-and-off assembly aid, Vario XtraFix, ISOVER makes a decisive step forward. The affixing function enables rapid and precise installation of the Vario XtraSafe Intelligent membrane, since it is simply stuck to the underlying surface and the membrane attached over it. Staple holes are avoided by the airtight surface.



VARIO KM DUPLEX MEMBRANE

VARIO KM Duplex UV a water vapour retardant, non-woven, laminated climate membrane for sealing and moisture protection in lightweight and solid construction.



VARIO KB1

Single sided adhesive tape for fixing membrane overlapping seams.



VARIO MULTITAPE SL

Adhesive Tape with split release - MultiTape SL creates a strong air-tight bond even in tricky areas such as corners, connections and penetrations where plastering is not required.



VARIO DOUBLEFIT SEALANT

Universal sealant - a 2-in-1 solution for creating air-tight joints between vapour membrane and adjacent surfaces.



ECRAN ROOFING MEMBRANE

Ecran is a new "next generation" breathable roofing underlay membrane. It is water resistant, very strong and is a vital component for creating an airtight, vapour control system.

A tape for block & masonry applications to create an airtight joint between ceilings, roofs & walls



Application:

Ceiling to Wall Detail

STEP 1

Install Isover insulation and and Isover airtight membrane on the ceiling section.

STEP 2

Cut the Vario membrane with a 15mm lip down the wall or timber wallplate.

STEP 3

Apply 15mm edge strip from Vario Bond to Vario membrane.



STEP 4

Remove centre strip from Vario Bond and apply to background.

STEP 5

Remove end strip from Vario Bond ensuring coverage over the timber wallplate to wall.

STEP 6

Use roller to firmly ensure good adhesion to background.

STEP 7

Install corner pieces at junctions and Proceed with plastering of walls and plasterboard to ceilings.

Application:

Wall to Floor Detail



STEP 1

The surface where the tape is installed should be free of dust/fibres and must be dry (e.g. free from moisture, ice or frost) which would prevent contact of the adhesive with the surface.



STEP 2

Apply Vario DoubleFit as primer if required.

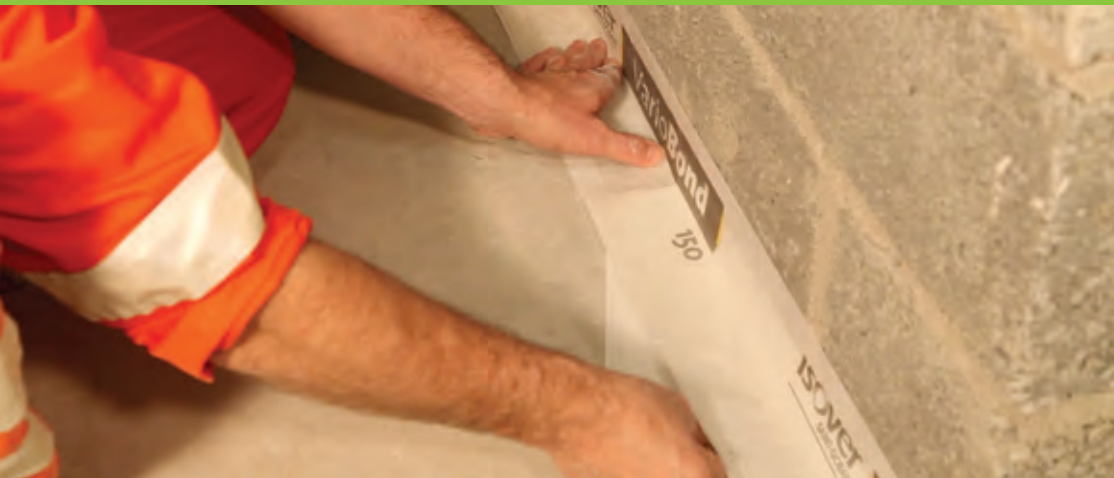

STEP 3

Apply the 15mm edge strip from Vario Bond to the wall section. Then apply the centre and end strip to the wall and floor section.



STEP 4

Apply plaster or sand & cement as required.

Application:
Reveal with
Cavity Closer



STEP 1

Install corner pieces at junctions.



STEP 2

Apply 15mm edge strip to window frame.

A tape for block & masonry applications to create an airtight joint between windows and walls.



STEP 3

Remove centre strip from Vario Bond and apply to background.



STEP 4

Remove end strip from Vario Bond and apply to background. Smooth the tape with a roller to ensure air bubbles are removed.



STEP 5

Proceed with plaster / plasterboard preparation.



STEP 6

Apply plasterboard to reveal with to manufacturers recommendations.

Metal & Concrete Window Lintel Details



STEP 1

Install corner pieces at junctions.



STEP 2

Apply 15mm edge strip to window frame.



STEP 3

Remove centre strip from Vario Bond and apply to background.



STEP 4

Remove end strip from Vario Bond and apply to background.



STEP 5

For concrete Lintels, Cut an additional length of Vario Bond at perimeter to allow return under lintel.



STEP 6

Overlap the installed Vario Bond.



STEP 7

Seal the tape applied to the concrete or metal lintel with a roller.



STEP 8

Proceed with plastering.

Application:

Window Cill Detail



STEP 1

Install corner pieces at junctions. For guidance on how to do this, please see the 'good practice' section of this guide.



STEP 2

Apply 15mm edge strip to window frame, ensuring the cill is free from dust and debris first. Apply Vario Double Fit as a primer before installation, if needed.



STEP 3

Remove centre strip from Vario Bond and apply to background.

STEP 4

Remove end strip from Vario Bond and apply to background.

STEP 5

Use roller to firmly ensure good adhesion to background.

GOOD PRACTICE



STEP 1

Take a 50mm width of tape and cut at midpoint along 15mm edge.

STEP 2

Partially remove backing on one side and fold.

STEP 3

Remove backing from other side and fold to create corner piece.

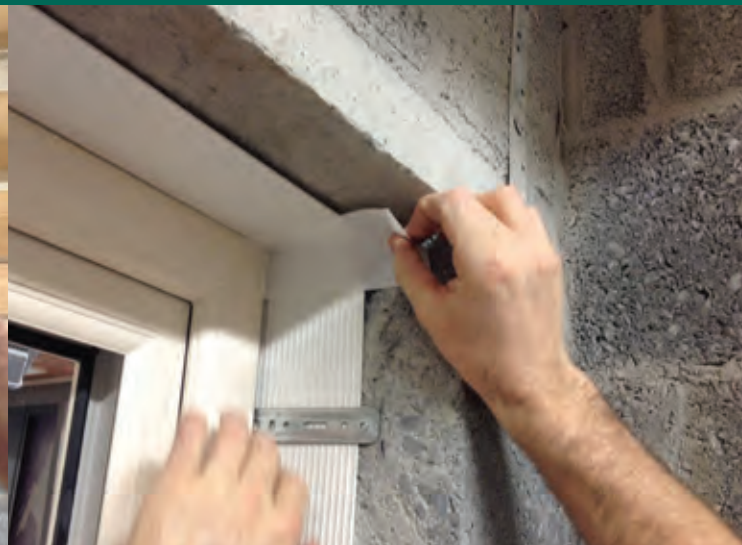

STEP 4

Insert corner piece to junction and apply edge piece to window frame.

STEP 5

Remove middle and end backing and ensure good adhesion, with no air bubbles.

STEP 6

Installed corner piece. Proceed with installation of tape over the corner pieces on the remaining surfaces of the application.

ISOVER IRELAND
Unit 4 Kilcarbery Business Park,
Nangor Road, Dublin 22
Tel: +353 (0) 1 6298400
Web: www.isover.ie

ISOVER Technical Team
Email: tech.ie@saint-gobain.com
Free Phone ROI: 1800 744 480
NI: 084 53990159

